

# KERANI HEIGHTS

## STAGE 3 STREETSCAPES

PROJECT NUMBER: 305538

### LANDSCAPE ARCHITECTURE DRAWINGS

### FOR URBANBASE

DRAWING SCHEDULE

DRAWING NO.	DESCRIPTION	SHEET NO.	REVISION
LD100	COVER - SHEET 1	1	A
LD700	PLANTING PLANS - SHEET 1	2	A
LD701	PLANTING PLANS - SHEET 2	3	A
LD900	DETAILS - SHEET 1	4	A
LD901	DETAILS - SHEET 2	5	A
LD902	DETAILS - SHEET 3	6	A

PLANTING SCHEDULE - TREES						
CODE	BOTANICAL NAME	COMMON NAME	DENSITY	INSTALL SIZE	MATURE SIZE (h x w)	QTY
Cc	<i>Corymbia citriodora</i>	Lemon-scented Gum	as shown	min. 1.8m tall, 45L	20 x 8	4
Ed	<i>Eucalyptus leucoxylon</i> 'Eukey'	Eukey Dwarf	as shown	min. 1.8m tall, 45L	6 x 5	6
EI	<i>Eucalyptus leucoxylon</i> 'Rosea'	Rosea Yellow Gum	as shown	min. 1.8m tall, 45L	13 x 7	6
Gt	<i>Gliditsia triacanthos</i> var. <i>inermis</i> 'Shademaster'	Green Honey Locast	as shown	min. 1.8m tall, 45L	12 x 10	23
Total						39

ALL TREE STOCK TO CONFORM TO AS 2303:2018; APPENDIX D.  
ALL TREE STOCK OF 50L TO HAVE A HEIGHT OF 1.5m - 2.0m AND CALIPER OF 25mm - 30mm  
UNLESS APPROVED IN WRITING BY THE SUPERINTENDENT

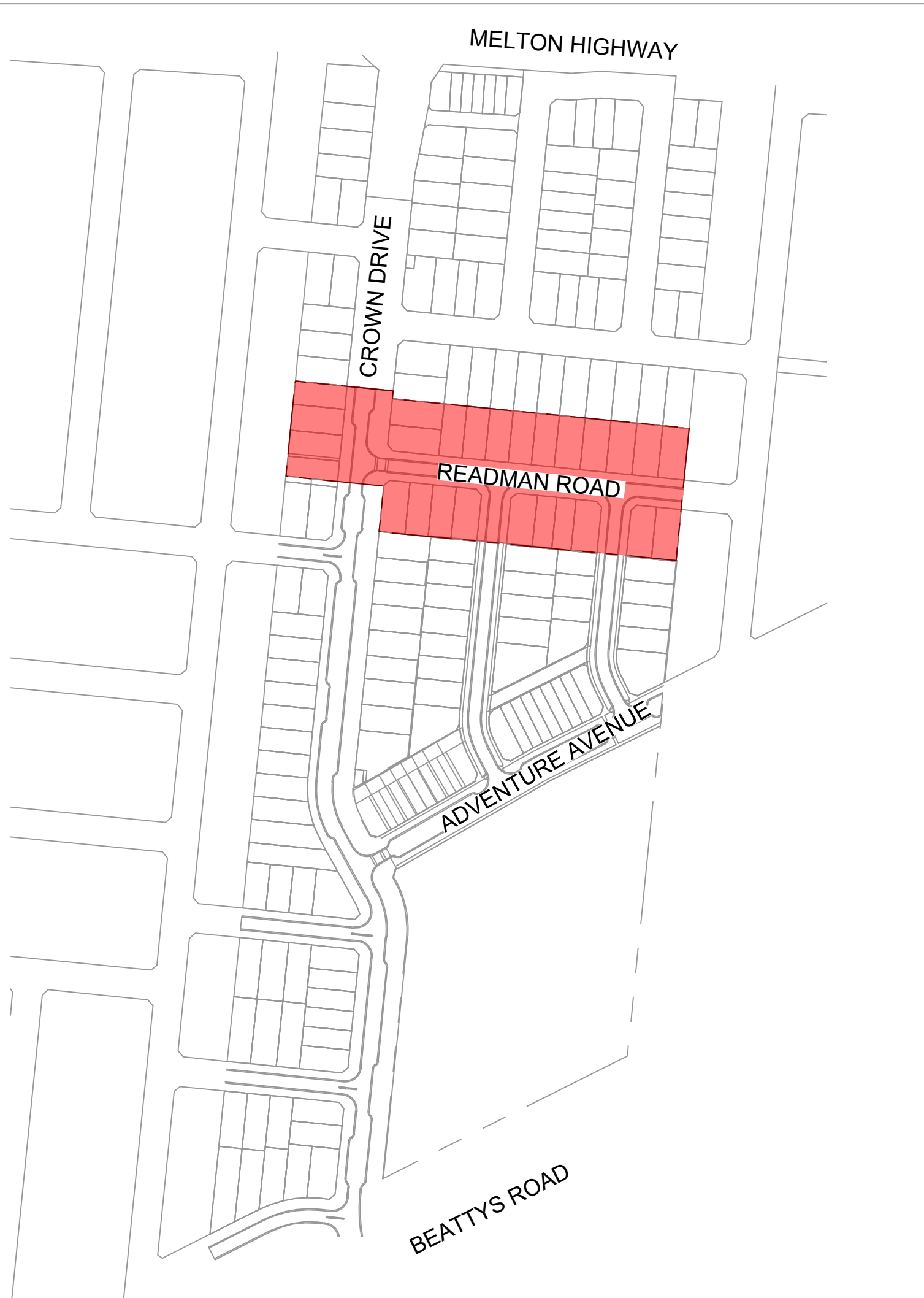

GENERAL NOTES

- Unless otherwise specified on the drawings all measurements, lengths, heights and distances to be determined from dimensions and NOT scaled off the drawings.
- Before commencement of any works it is the responsibility of the Landscape Contractor to contact Dial Before You Dig 1100 (Fax 1300 652 077) for information on services in the area shown on the plan (www.dialbeforeyoudig.com.au)
- The locations of underground services are approximate only and their exact position should be proven on site. No guarantee is given that all existing services are shown. The Contractor shall verify the location and depth of all services prior to commencing on site.
- The Contractor must have a copy of Melbourne One Call/Services information and plans on site at all times.
- The Contractor shall be liable for any damage to services during landscape works.
- All trees shall be planted in locations shown on this plan, with setback to be approved on site by the Superintendent prior to planting.
- Tree canopies are shown at 75% of mature diameter.
- Any change in plant species must have the approval of the Superintendent.
- Trees shall not be planted less than the following distances from existing elements, unless otherwise stated in the documentation:
  - Pedestrian pathways - 1.2m
  - Pedestrian pathways in reserve - 2.0m
  - Driveways and crossovers - 3.0m
  - Stormwater and sewerage pits - 2.0m
  - Intersections - 10.0m
  - Service crossings - 2.0m
  - Back of Kerb - 1.0m min.
  - Street lights and power poles - 4.0m
  - Service assets, incl. junction boxes, pits etc - 2.0m
  - Fire plugs - 3.0m
- The Superintendent is to inspect trees supplied by the Contractor prior to planting.
- The Principal will ensure that all property boundaries are to be pegged out by licensed surveyors prior to set out of landscape works.
- All drawings 'For Construction' to be printed in colour

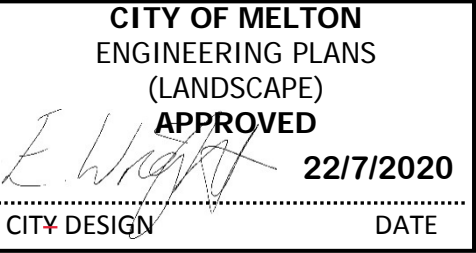

spiire

© Spiire Australia Pty Ltd All Rights Reserved  
This document is produced by Spiire Australia Pty Ltd solely for the benefit of and use by the client in accordance with the terms of the retainer. Spiire Australia Pty Ltd does not and shall not assume any responsibility or liability whatsoever to any third party arising out of any use or reliance by third party on the content of this document.

414 LA TROBE STREET PO BOX 16084 MELBOURNE  
VICTORIA 8007 AUSTRALIA T 61 3 9993 7888  
www.spiire.com.au ABN 55 050 029 635

PRELIMINARY

B	ISSUED FOR APPROVAL	MB	27/07/20
A	PRELIMINARY ISSUE	MB	20/07/20
REV	DESCRIPTION	APP	DATE

KERANI HEIGHTS

STAGE 3 STREETSCAPES

DETAILED DESIGN

COVER - SHEET 1

SHEET 1 OF 6

CITY OF MELTON

URBANBASE

N

MGA 94 ZONE

1:1000 SCALE @ A1

0 10 20 30 40 50

DESIGNED  
SF

DRAWN  
SF

CHECKED  
MS

APPROVED  
MB

DATE  
20/07/2020

DRG NO.  
305538LD100

REV  
B

file name: 305538LD100.dwg, layout: kerani LD100, plotted by: Matthew Bradbury, file location: G:\305538\Kerani\stage3\ACAD\plot date: 27/07/2020 5:11 PM Sheet 1 of 6 Sheets



LEGEND

- EXTENT OF WORKS
- EXISTING STORMWATER  
By others / refer Civil
- EXISTING CONDUITS / SERVICES  
By others / refer Civil
- EXISTING STREET LIGHTS  
Refer Power
- STREET TREE  
Refer Schedules, Details and Specification
- GRASS  
Refer Details and Specification
- PASSIVE IRRIGATION GRAVEL TRENCH  
(COUNCIL STANDARD DETAIL)  
As scheduled, detailed and specified
- 3M ELECTRICAL JOINT AND  
CONDUIT END OFFSET
- 4M LIGHT POLE AND  
PARALLELING PILLAR OFFSET

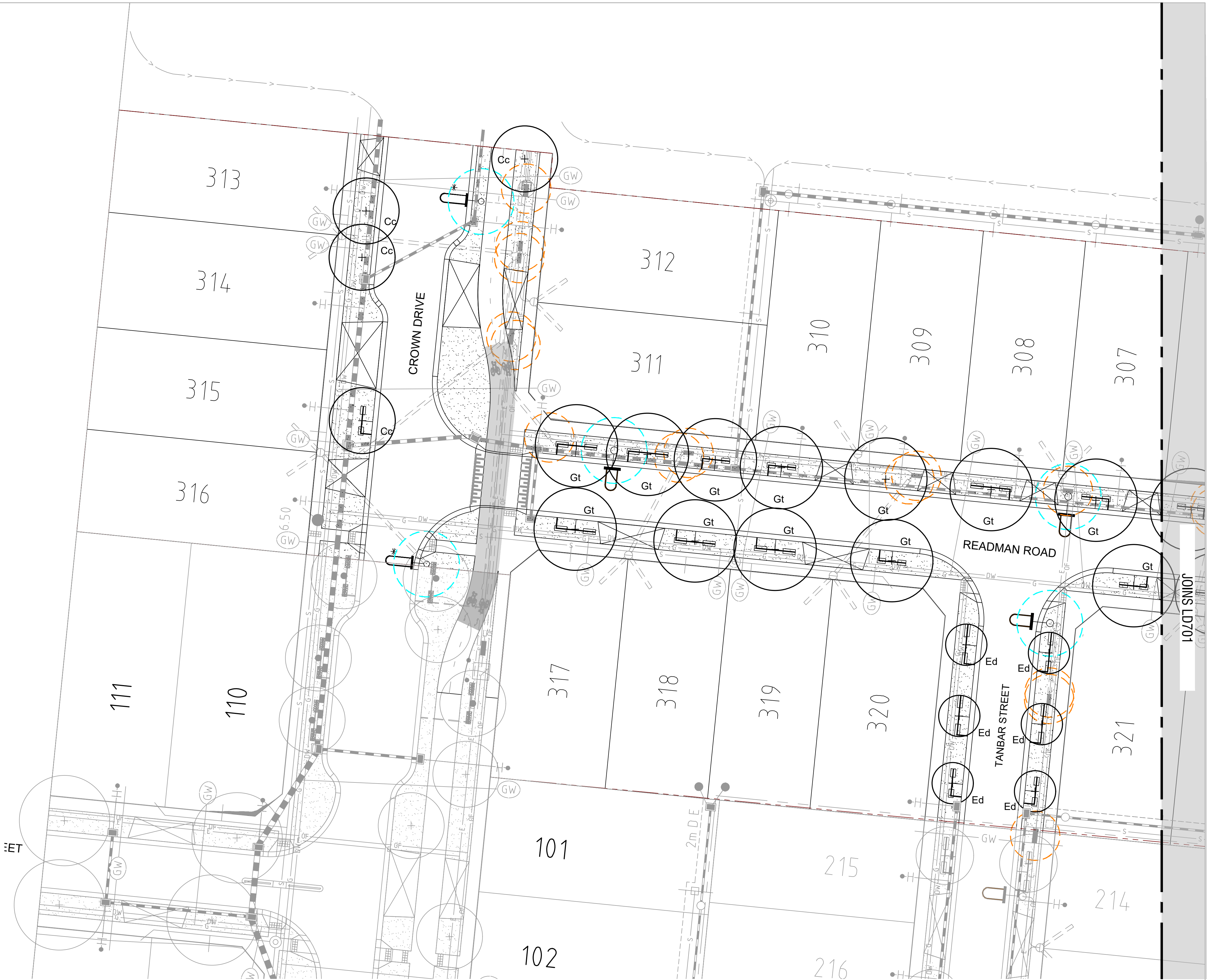

NOTES

CITY OF MELTON  
ENGINEERING PLANS  
(LANDSCAPE)  
APPROVED  
22/7/2020  
CITY DESIGN DATE

spiire

© Spiire Australia Pty Ltd All Rights Reserved  
This document is produced by Spiire Australia Pty Ltd solely for the benefit of and use by the client in accordance with the terms of the retainer. Spiire Australia Pty Ltd does not and shall not assume any responsibility or liability whatsoever to any third party arising out of any use or reliance by third party on the content of this document.

414 LA TROBE STREET PO BOX 16084 MELBOURNE  
VICTORIA 8007 AUSTRALIA T 61 3 9993 7888  
www.spiire.com.au ABN 55 050 029 635

PRELIMINARY

B	ISSUED FOR APPROVAL	MB	27/07/20
A	PRELIMINARY ISSUE	MB	20/07/20
REV	DESCRIPTION	APP	DATE

KERANI HEIGHTS  
STAGE 3 STREETSCAPES

DETAILED DESIGN

PLANTING PLANS - SHEET 1

SHEET 2 OF 6

CITY OF MELTON  
URBANBASE

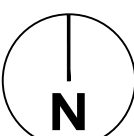

MGA 94  
ZONE  
1:250  
SCALE @ A1  
0 2.5 5 7.5 10 12.5

DESIGNED  
SF  
DRAWN  
SF  
CHECKED  
MS  
APPROVED  
MB

DATE  
20/07/2020  
DRG NO.  
305538LD700  
REV  
B



file name: 305538LD700.dwg layout: kerani LD701 plotted by: Matthew Bradbury  
file location: G:\305538\Landscapes\ACAD\plot date: 27/07/2020 5:11 PM Sheet 3 of 6 Sheets

LEGEND

- EXTENT OF WORKS
- EXISTING STORMWATER  
By others / refer Civil
- EXISTING CONDUITS / SERVICES  
By others / refer Civil
- EXISTING STREET LIGHTS  
Refer Power
- STREET TREE  
Refer Schedules, Details and Specification
- GRASS  
Refer Details and Specification
- PASSIVE IRRIGATION GRAVEL TRENCH  
(COUNCIL STANDARD DETAIL)  
As scheduled, detailed and specified
- 3M ELECTRICAL JOINT AND  
CONDUIT END OFFSET
- 4M LIGHT POLE AND  
PARALLELING PILLAR OFFSET



NOTES

CITY OF MELTON  
ENGINEERING PLANS  
(LANDSCAPE)  
APPROVED

*E. Whelan*  
CITY DESIGN

22/7/2020  
DATE

spiire

© Spiire Australia Pty Ltd All Rights Reserved  
This document is produced by Spiire Australia Pty Ltd solely for the benefit of and use by the client in accordance with the terms of the retainer. Spiire Australia Pty Ltd does not and shall not assume any responsibility or liability whatsoever to any third party arising out of any use or reliance by third party on the content of this document.

414 LA TROBE STREET PO BOX 16084 MELBOURNE  
VICTORIA 8007 AUSTRALIA T 61 3 9993 7888  
www.spiire.com.au ABN 55 050 029 635

PRELIMINARY

B	ISSUED FOR APPROVAL	MB	27/07/20
A	PRELIMINARY ISSUE	MB	20/07/20
REV	DESCRIPTION	APP	DATE

KERANI HEIGHTS  
STAGE 3 STREETSCAPES

DETAILED DESIGN

PLANTING PLANS - SHEET 2

SHEET 3 OF 6

CITY OF MELTON  
URBANBASE

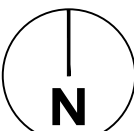

MGA 94  
ZONE

1:250  
SCALE @ A1

0 2.5 5 7.5 10 12.5

DESIGNED SF	DRAWN SF	CHECKED MS	APPROVED MB
DATE 20/07/2020	DRG NO. 305538LD701	REV B	

file name: 305538LD900.dwg, layout name: LD900, plotted by: Matthew Bradbury,  
file location: G:\305538\Landscapes\ACAD\plot date: 27/07/2020 5:11 PM Sheet 4 of 6 Sheets

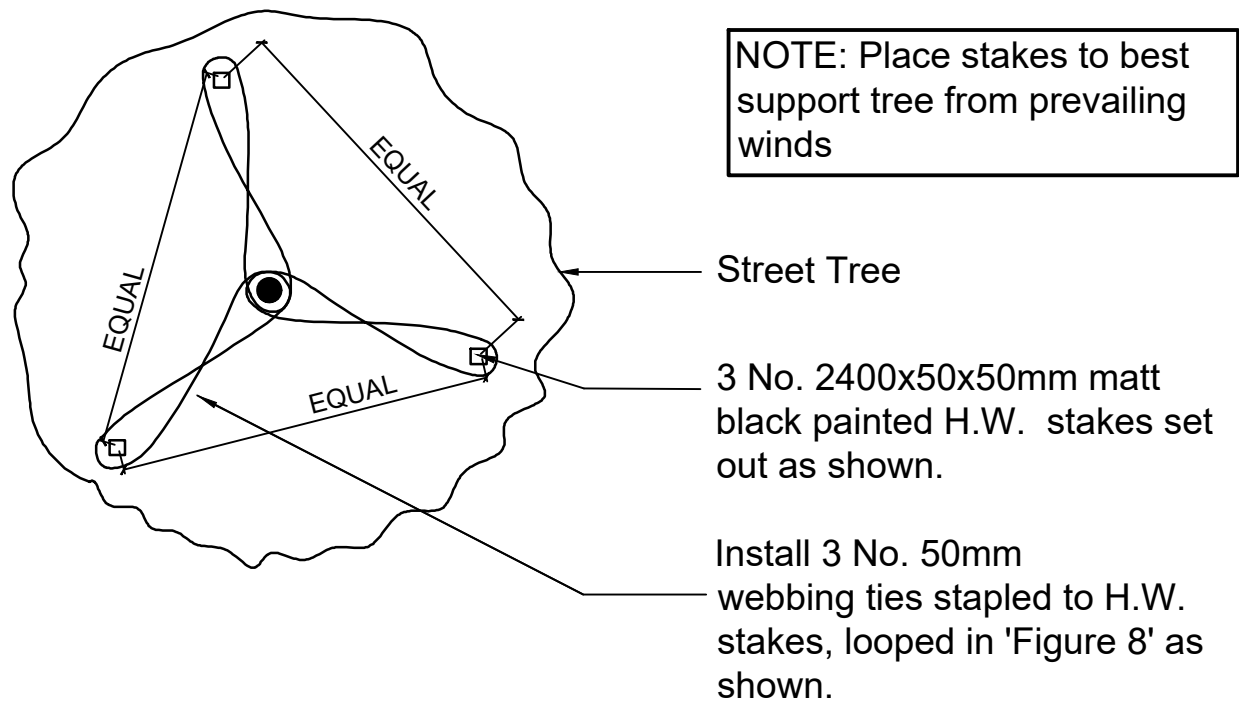
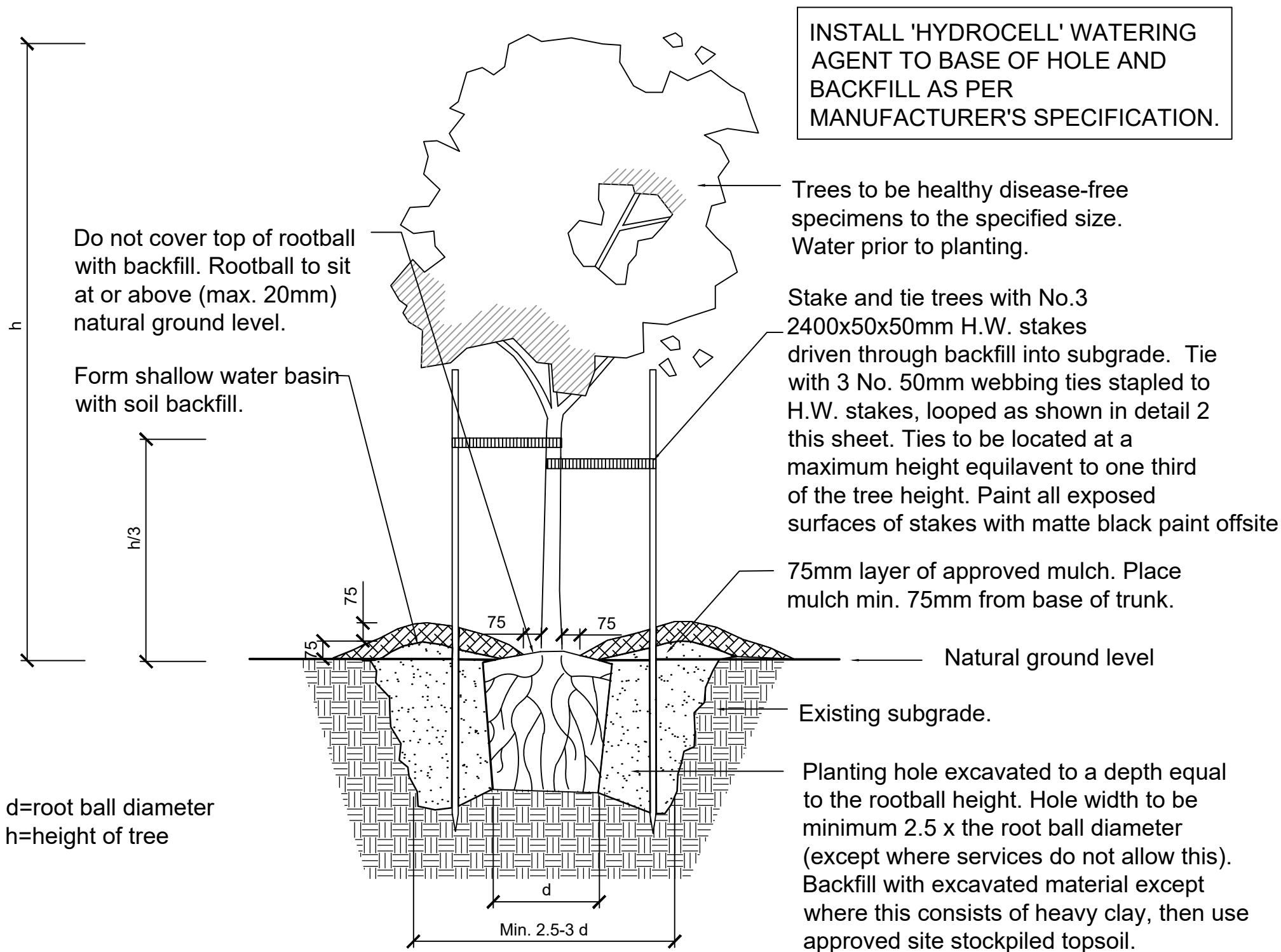

## 1 SEMI-ADVANCED TREE PLANTING DETAIL

Scale 1:20 @ A1

## NOTES

- Existing pasture grass and/or weeds are to be sprayed with herbicide.
- No machinery to be used within the drip line of existing trees.
- Topsoil to be raked to a fine tilth, removal of all surface rocks, large lumps of clay, weeds and rubbish prior to application of seed to all areas as shown.
- New grassed areas to be protected from trespass and traffic with star pickets and barrier rope until grass is established.

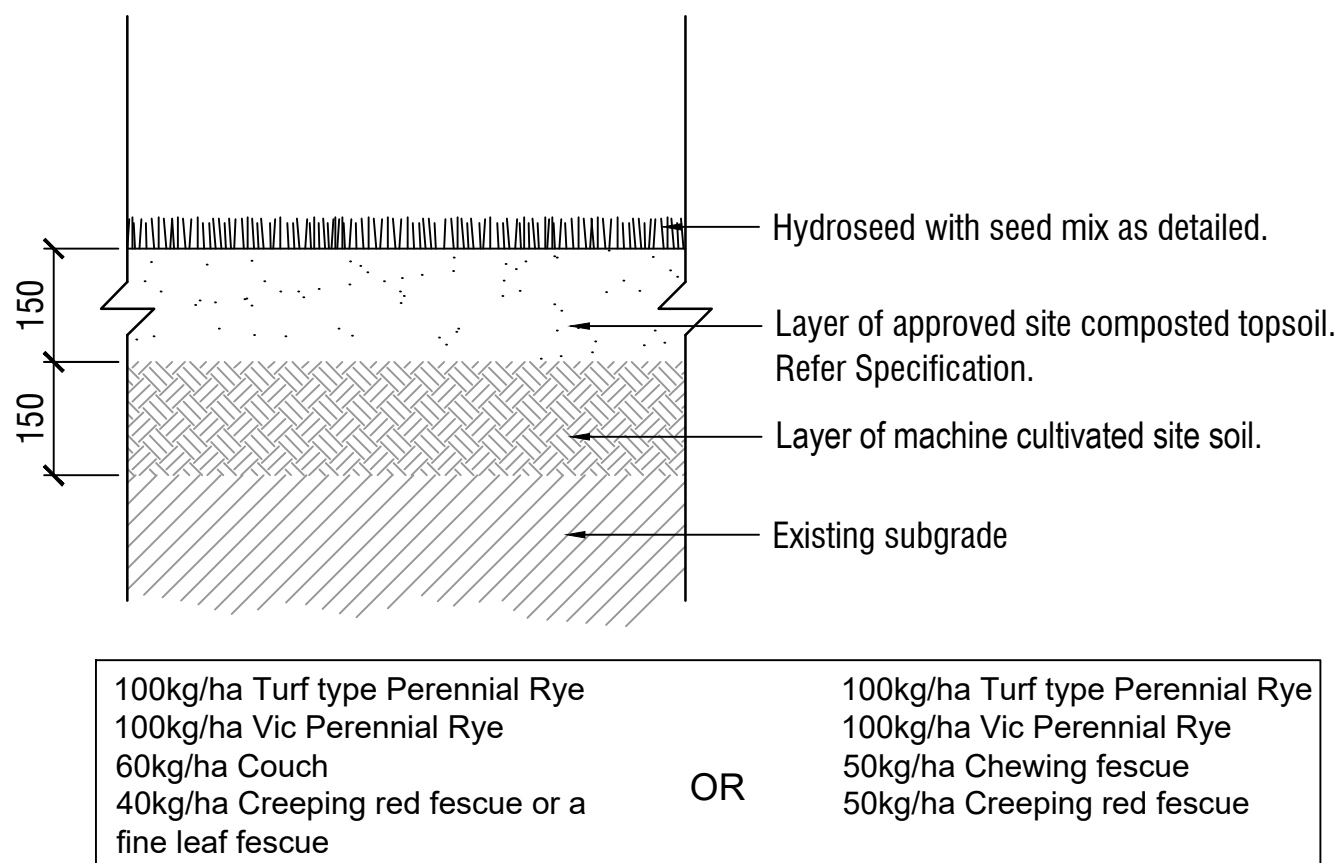

## 2 HYDROSEED DETAIL

Scale 1:10 @ A1

## NOTES

CITY OF MELTON	
ENGINEERING PLANS	
(LANDSCAPE)	
APPROVED	
<i>E. Wright</i>	22/7/2020
CITY DESIGN	DATE

# spiire

© Spiire Australia Pty Ltd All Rights Reserved  
This document is produced by Spiire Australia Pty Ltd solely for the benefit of and use by the client in accordance with the terms of the retainer. Spiire Australia Pty Ltd does not and shall not assume any responsibility or liability whatsoever to any third party arising out of any use or reliance by third party on the content of this document.

414 LA TROBE STREET PO BOX 16084 MELBOURNE  
VICTORIA 8007 AUSTRALIA T 61 3 9993 7888

www.spiire.com.au

ABN 55 050 029 635

## PRELIMINARY

B	ISSUED FOR APPROVAL	MB	27/07/20
A	PRELIMINARY ISSUE	MB	20/07/20
REV	DESCRIPTION	APP	DATE

## KERANI HEIGHTS STAGE 3 STREETSCAPES

### DETAILED DESIGN

DETAILS - SHEET 1

SHEET 4 OF 6

CITY OF MELTON

URBANBASE



## AS SHOWN

DESIGNED	DRAWN	CHECKED	APPROVED
SF	SF	MS	MB
DATE	DRG NO.	REV	
20/07/2020	305538LD900	B	







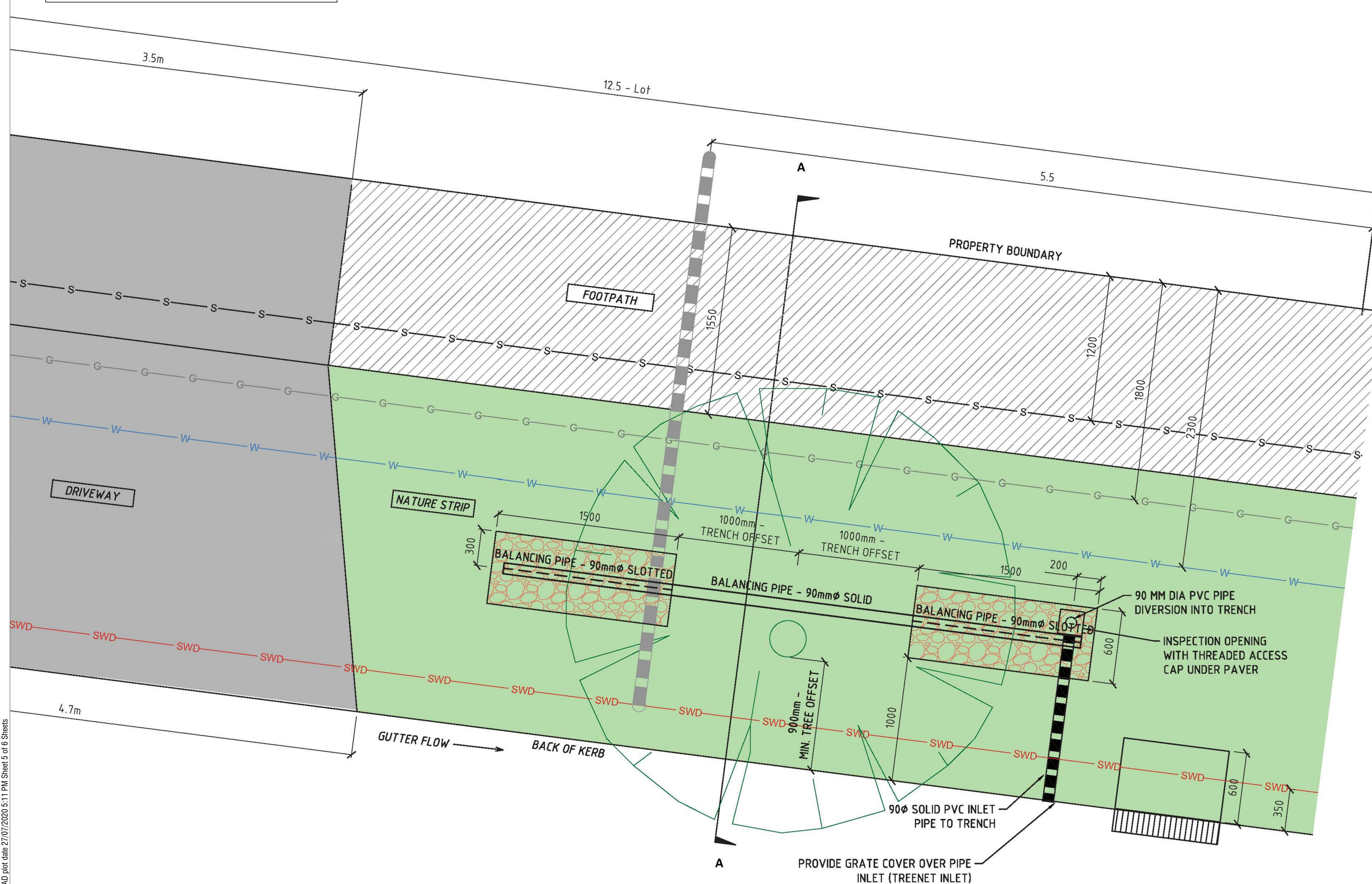

### REMAINING SUPPLY AND INSTALLATION OF PASSIVE IRRIGATION TREE PIT BY LANDSCAPE CONTRACTOR

### REMAINING SUPPLY AND INSTALLATION OF PASSIVE IRRIGATION TREE PIT BY LANDSCAPE CONTRACTOR



## LEGEND

	S	SEWER
	G	GAS
	W	POTABLE WATER
	SWD	STORM WATER DRAIN
		GRAVEL TRENCH - (rail ballast nominal size 50mm)
		BALANCING PIPE - 90mm Ø (slotted section within gravel trench)
		BALANCING PIPE - 90mm Ø (solid pipe section between gravel trenches)

**CITY OF MELTON**  
**ENGINEERING PLANS**  
**(LANDSCAPE)**  
**APPROVED**  
*E. Wright* **22/7/2022**  
CITY DESIGN DATE

**spiire**

© Spiire Australia Pty Ltd All Rights Reserved  
This document is produced by Spiire Australia Pty Ltd solely for the benefit of and use by the client in accordance with the terms of the retainer. Spiire Australia Pty Ltd does not and shall not assume any responsibility or liability whatsoever to any third party arising out of any use or reliance by third party on the content of this document.

**414 LA TROBE STREET PO BOX 16084 MELBOURNE  
VICTORIA 8007 AUSTRALIA T 61 3 9993 7888**  
www.spiire.com.au ARN 55 050 029 635

# PRELIMINARY

B	ISSUED FOR APPROVAL	MB	27/07/20
A	PRELIMINARY ISSUE	MB	20/07/20
REV	DESCRIPTION	APP	DATE

## KERANI HEIGHTS

### STAGE 3 STREETSCAPES

## DETAILED DESIGN

**DETAILS - SHEET 2**

SHEET 5 OF 6

CITY OF MELTON  
URBANBASEMGA 9.  
ZONE

DESIGNED **SF** DRAWN **SF**

DRAWN  
SF

DATE  
20/07/2020

AS SHOWN

DESIGNED **SF** DRAWN **SF**

DATE  
20/07/2020

CHECKED MS APPROVED MB

DATE	DRG NO.	RE
20/07/2020	305538LD901	B

### PASSIVE STREET TREE IRRIGATION GRAVEL TRENCH - PLAN

Scale 1:10 @ A1

## MELTON CITY COUNCIL STANDARD DETAIL

file name 305538LD900.dwg layout name LD901 plotted by Matthew Bradbury  
file location G:\30\305538\Landscape\ACAD plot date 27/07/2020 5:11 PM Sheet 5 of 6 Sheets



NOTES:

TOP OF GRAVEL TRENCH TO BE LINED WITH NON-WOVEN GEOTEXTILE MATERIAL AS SHOWN TO PREVENT FINE MIGRATION INTO THE TRENCH

PASSIVE IRRIGATION PIPES AND FITTINGS TO BE 90 MM DIAMETER PVC SEWER CLASS

ALL PVC JOINTS TO BE SEALED WITH SOLVENT CEMENT

ALL GRASSED AREAS TO BE TOP DRESSED WITH 100 MM TOPSOIL AND SEEDED AS SPECIFIED

SERVICE DEPTHS AND LOCATIONS ARE INDICATIVE ONLY

NOTE:

CIVIL CONTRACTOR TO ONLY PROVIDE INLET AND 90Ø PVC PIPE (UP TO 900mm FROM BACK OF KERB).

REMAINING SUPPLY AND INSTALLATION OF PASSIVE IRRIGATION TREE PIT BY LANDSCAPE CONTRACTOR

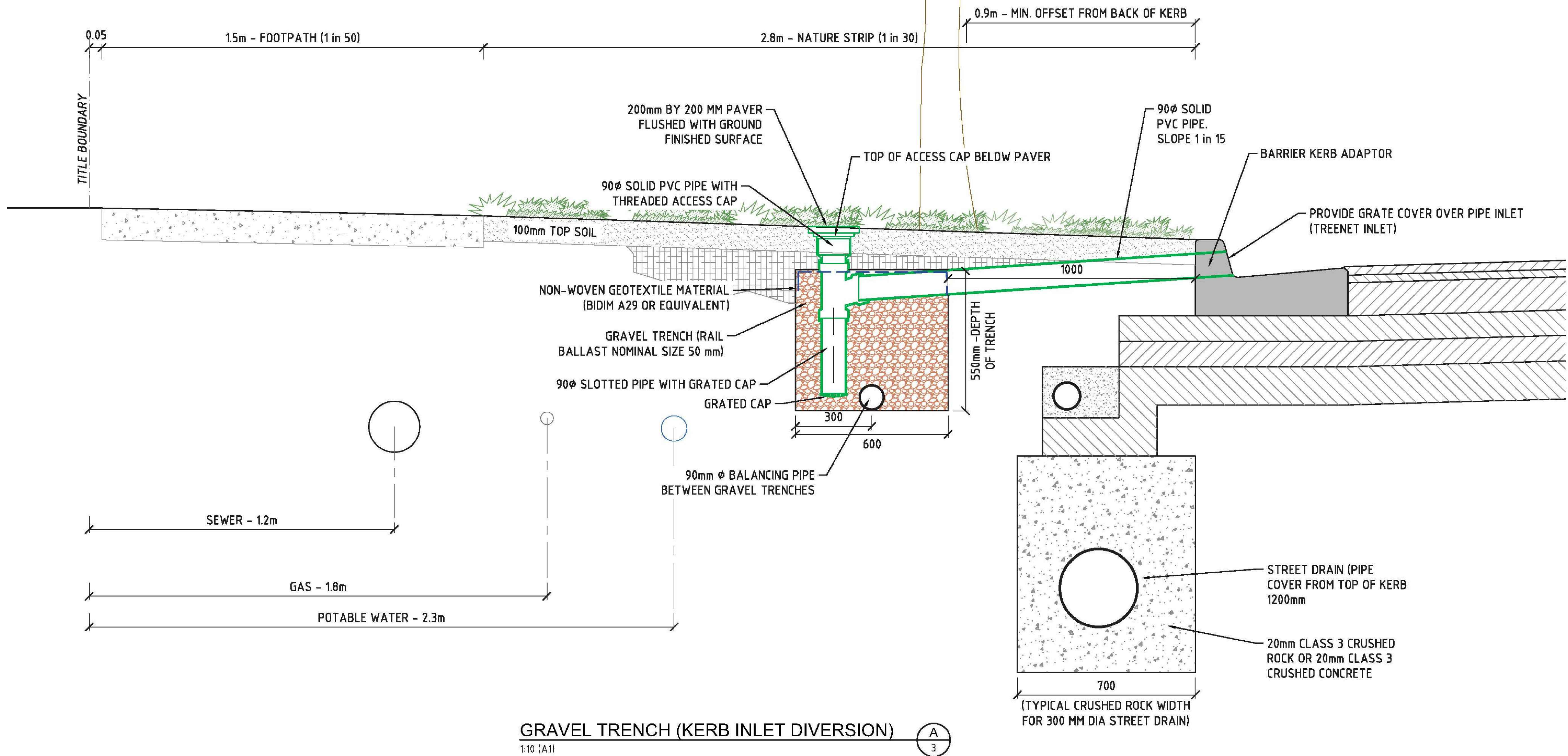

TREENET INLET

NOTES

CITY OF MELTON  
ENGINEERING PLANS  
(LANDSCAPE)  
APPROVED  
22/7/2020  
CITY DESIGN DATE

spiire

© Spiire Australia Pty Ltd All Rights Reserved  
This document is produced by Spiire Australia Pty Ltd solely for the benefit of and use by the client in accordance with the terms of the retainer. Spiire Australia Pty Ltd does not and shall not assume any responsibility or liability whatsoever to any third party arising out of any use or reliance by third party on the content of this document.

414 LA TROBE STREET PO BOX 16084 MELBOURNE  
VICTORIA 8007 AUSTRALIA T 61 3 9993 7888  
www.spiire.com.au ABN 55 050 029 635

PRELIMINARY

B	ISSUED FOR APPROVAL	MB	27/07/20
A	PRELIMINARY ISSUE	MB	20/07/20
REV	DESCRIPTION	APP	DATE

KERANI HEIGHTS  
STAGE 3 STREETSCAPES

DETAILED DESIGN  
DETAILS - SHEET 3  
SHEET 6 OF 6  
CITY OF MELTON  
URBANBASE



AS SHOWN

DESIGNED SF	DRAWN SF	CHECKED MS	APPROVED MB
DATE 20/07/2020	DRG NO. 305538LD902	REV B	

PASSIVE STREET TREE IRRIGATION GRAVEL TRENCH - CROSS SECTION

Scale 1:10 @ A1

MELTON CITY COUNCIL STANDARD DETAIL